

8 7 6 5 4 3 2 1

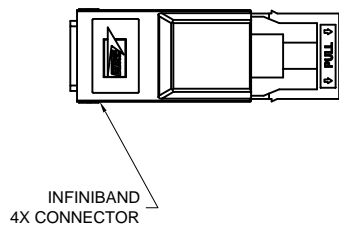

26 AWG CABLE
105 OHM DIFFERENTIAL PAIR (8X)

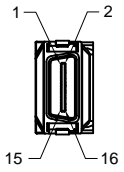
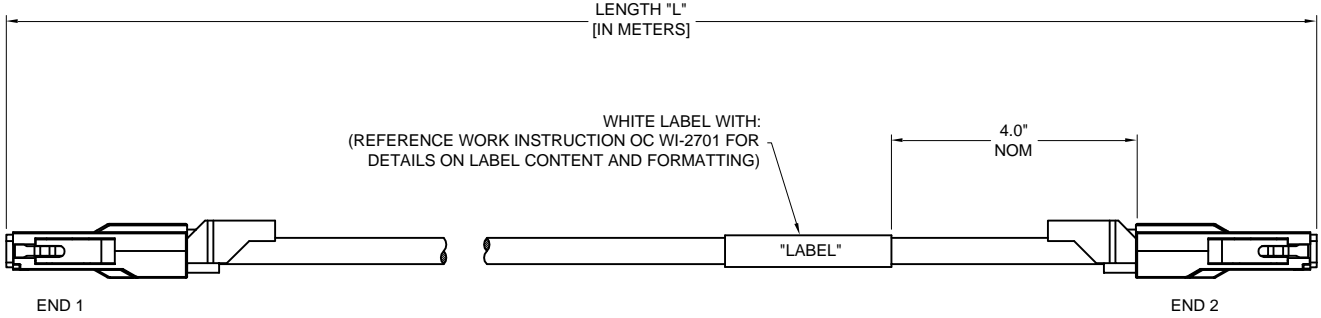
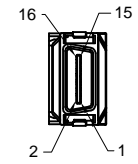
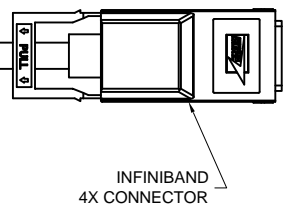

NOTES:

- 1- DIFFERENTIAL Z_0 SHALL BE 105 ± 5 OHMS BETWEEN LEGS OF ANY DIFFERENTIAL PAIR.
- 2- MAXIMUM DIFFERENTIAL SKEW BETWEEN LEGS OF ANY DIFFERENTIAL PAIR IS RECOMMENDED TO BE LESS THAN 120 PSEC.
- 3- CROSSTALK: $< 4\%$
- 4- MINIMUM EYE DIMENSIONS: HEIGHT: 316 mV, WIDTH: 300ps, JITTER: 100 ps.
- 5- MAXIMUM ASSEMBLY INSERTION LOSS: 10dB @ 1.25 GHz
- 6- LENGTH TOLERANCE: 5 METERS AND UNDER +4.0 INCHES/-0.0 INCHES
OVER 5 METERS +6.0 INCHES/-0.0 INCHES
- 7- CABLE EMI SHIELD SHALL BE TERMINATED TO BOTH CONNECTOR SHELLS.
- 8- CUSTOMER WILL SPECIFY LENGTH (IN METERS) BY INSERTING DESIRED LENGTH AS A DASH NUMBER AFTER THE IBN PART NUMBER WHEN ORDERING.
- 9- CONNECTOR PINOUT AND DETAIL ON PAGE 2.

W. L. GORE & ASSOCIATES, INC. (Gore)
Electronic Products Division
P.O. Box 160, Elkton, Maryland 21922-0160
© 2003 W. L. Gore & Associates, Inc.

By acceptance of this document you agree that all rights to drawings, specifications, processes and other data contained therein, as well as the proprietary and novel features of the subject matter, are reserved by Gore and are disclosed in confidence. They are not to be manufactured, used, sold or disclosed to others, nor are devices embodying such features or information derived from these disclosures to be used or disclosed, unless and until expressly authorized by Gore. These drawings, specifications, processes, etc., are and remain the property of Gore and are not to be copied or reproduced without express permission, and are to be returned upon request therefor.

DEFECT CLASSIFICATION KEY <small>Absence of a defect symbol from any feature indicates minor classification</small>	DIMENSIONS ARE IN INCHES	UNLESS OTHERWISE SPECIFIED	Drawn ECL 19 FEB 2003	Check	Approval
▼ Critical Feature	DO NOT SCALE DRAWING	.X ± N/A	Material N/A		
▽ Major 1 Feature	DEBURR SHARP EDGES	.XX ± N/A	Heat Treat N/A		
▽ Major 2 Feature		.XXX ± N/A	Finish N/A		
▽ Plating Verification	INTERPRET DRAWING IN ACCORDANCE WITH ASME Y14.5M-1994 (R1994)	FRACTIONS ± N/A	Title INFINIBAND 4X ASSEMBLY - IBN4600-L		
		ANGLES ± N/A	Dwg Size C	Sheet 1 of 2	Scale 1:1
		SURFACE TEXTURE N/A ✓	Revision	Rev Date 17 MAY 2005	Drawing Number 54710078
		BREAKS AND FILLETS N/A MAX	Rev Description DCN NO 05-068		
			Rev Level D		

8 7 6 5 4 3 2 1

WIRING CHART			
END 1		END 2	
POS. #	ASSIGN	POS. #	ASSIGN
G1-G8	SIGNAL GROUND	G1-G8	SIGNAL GROUND
1	R+ (BIT 0)	16	T+ (BIT 0)
2	R- (BIT 0)	15	T- (BIT 0)
3	R+ (BIT 1)	14	T+ (BIT 1)
4	R- (BIT 1)	13	T- (BIT 1)
5	R+ (BIT 2)	12	T+ (BIT 2)
6	R- (BIT 2)	11	T- (BIT 2)
7	R+ (BIT 3)	10	T+ (BIT 3)
8	R- (BIT 3)	9	T- (BIT 3)
9	T- (BIT 3)	8	R- (BIT 3)
10	T+ (BIT 3)	7	R+ (BIT 3)
11	T- (BIT 2)	6	R- (BIT 2)
12	T+ (BIT 2)	5	R+ (BIT 2)
13	T- (BIT 1)	4	R- (BIT 1)
14	T+ (BIT 1)	3	R+ (BIT 1)
15	T- (BIT 0)	2	R- (BIT 0)
16	T+ (BIT 0)	1	R+ (BIT 0)
HOUSING	CHASSIS GROUND	HOUSING	CHASSIS GROUND

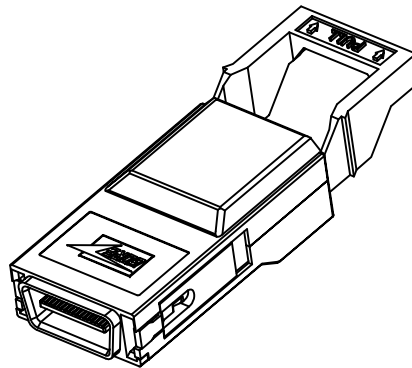
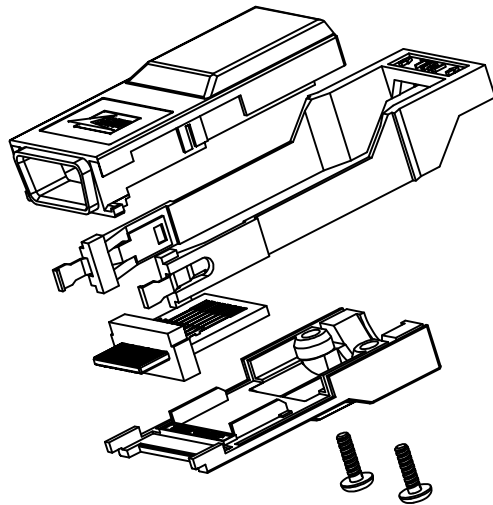
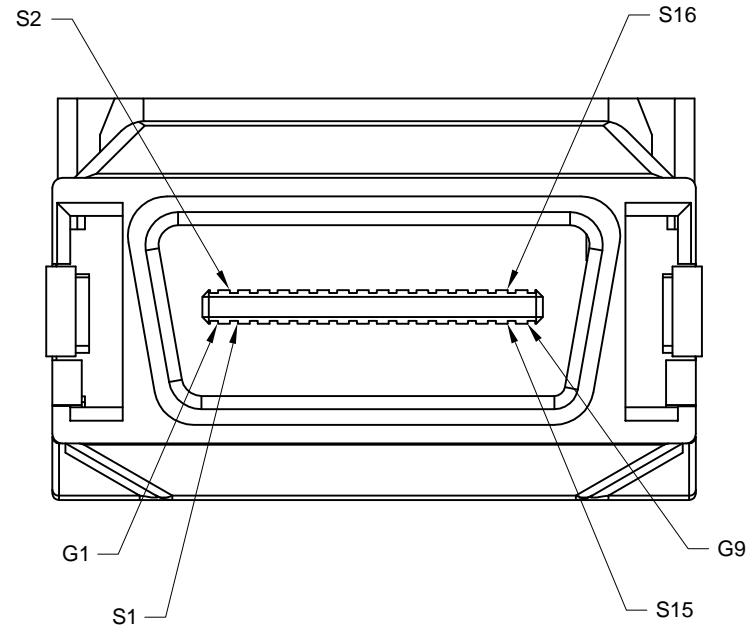

		W. L. GORE & ASSOCIATES, INC. (Gore) Electronic Products Division P.O. Box 160, Elkton, Maryland 21922-0160 <small>© 2003 W. L. Gore & Associates, Inc.</small>		<small>By acceptance of this document you agree that all rights to drawings, specifications, processes and other data contained therein, as well as the proprietary and novel features of the subject matter, are reserved by Gore and are disclosed in confidence. They are not to be manufactured, used, sold or disclosed to others, nor are devices embodying such features or information derived from these disclosures to be used or disclosed, unless and until expressly authorized by Gore. These drawings, specifications, processes, etc., are and remain the property of Gore and are not to be copied or reproduced without express permission, and are to be returned upon request therefor.</small>			
DEFECT CLASSIFICATION KEY <small>Absence of a defect symbol from any feature indicates minor classification</small>		DIMENSIONS ARE IN INCHES		UNLESS OTHERWISE SPECIFIED		Drawn ECL 19 FEB 2003 Check <input type="checkbox"/> Approval <input type="checkbox"/>	
▼	Critical Feature	DO NOT SCALE DRAWING	.X ± N/A	.XX ± N/A	.XXX ± N/A	Material	N/A
▽	Major 1 Feature	DEBURR SHARP EDGES	.XXXX ± N/A	FRACTIONS ± N/A	ANGLES ± N/A	Heat Treat	N/A
▽	Major 2 Feature	Third Angle Projection	SURFACE TEXTURE	N/A ✓	BREAKS AND FILLETS	Finish	N/A
Ⓟ	Plating Verification	INTERPRET DRAWING IN ACCORDANCE WITH ASME Y14.3M-1994 (R1994)	N/A	MAX		Title INFIBAND 4X ASSEMBLY - IBN4600-L	
						Dwg Size	C
						Sheet	2 of 2
						Scale	1:1
						Rev Date	17 MAY 2005
						Rev Description	DCN NO 05-068
						Drawing Number	54710078
						Rev Level	D