

ILLUSTRATED PARTS BREAKDOWN

application DEC 400_xP SYSTEM

ILLUSTRATED PARTS BREAKDOWN (IPB)

The IPB is used to identify a part and its location in a hardware product. The document references specific item numbers in the associated parts list.

HOW TO USE THE IPB

1. Locate the figure containing the item of interest.
2. Locate the number (callout) of the item of interest.
3. Locate that item number in the associated parts list.

FORMAT

Each IPB is generally organized based on its first figure. All other assemblies and subassemblies are referenced from this figure. Each figure contains numeric callouts of all major parts (items).

PARTS LIST

Each parts list contains the following:

Figure and Item No. – Lists the figure number and its referenced numeric callout

Description – Presents the name and a brief description of the item. A single asterisk (*) preceding the description

denotes item is a subassembly to its referenced figure. A double asterisk (***) preceding the description indicates that this item is subordinate to the preceding single asterisk item.

DEC Part No. – Lists the Digital/Vendor part number. The letter in the column heading indicates the current revision level of the Engineering Drawing for the referenced figure.

ECO Cut-In – Lists the top assembly drawing number and revision level at first printing. All additional revisions to an item are listed in this column.

Used On Code – Lists letters referring to the product variation assigned in Figure 1. When this column is blank, the item is used in all options.

Ref Fig No. – Lists a cross reference between figures within the IPB.

PART NUMBER/PART DESCRIPTION INDEX SECTION

Lists items by part number numerically, and description alphabetically. Items are also referenced to a location within the IPB by figure and item number.

ECO/REVISION HISTORY

**OTHER IPB
MANUALS
REFERENCED**

FIGURE NO.	ASSEMBLY	INITIAL LEVEL	CURRENT LEVEL	PRINTING DATE	OTHER IPB MANUALS REFERENCED
1	PS200	00000	00000	25-SEPT-92	N/A
1	PS201	00000	00000		
1	PS202	00000	00000		
1	PS203	00000	00000		
2	PS20A	00000	00000		
3	70-28257	00000	00000		

Digital Equipment Corporation reserves the right, without notice, to make substitutions and modifications in the specifications of products documented in this manual and further reserves the right to withdraw any of these products from the market without notice.

Digital Equipment Corporation is not responsible for errors which may appear in the technical description (including illustrations and photographs) of the products covered by this manual.

None of the descriptions contained in this manual imply the granting of any license whatsoever to make, use or sell equipment constructed in accordance therewith.

Restricted Rights: Use, duplication or disclosure by the U.S. Government is subject to restrictions as set forth in subparagraph (c) (1) (ii) of the Rights in Technical Data and Computer Software clause at DFARS 252.227-2713.

Copyright © 1992 by Digital Equipment Corporation. All rights reserved.
Printed in U.S.A.

The postage-paid READER'S COMMENTS form on the last page of this document requests your critical evaluation to assist us in preparing future documentation.

The following are trademarks of Digital Equipment Corporation :

applicationDEC, DECdirect, and the DIGITAL logo.

EISA is a trademark of Compaq Computer Corporation.

  INDICATES FRU LEVEL PARTS

 INDICATES OPTIONAL PARTS

PARTS LIST 

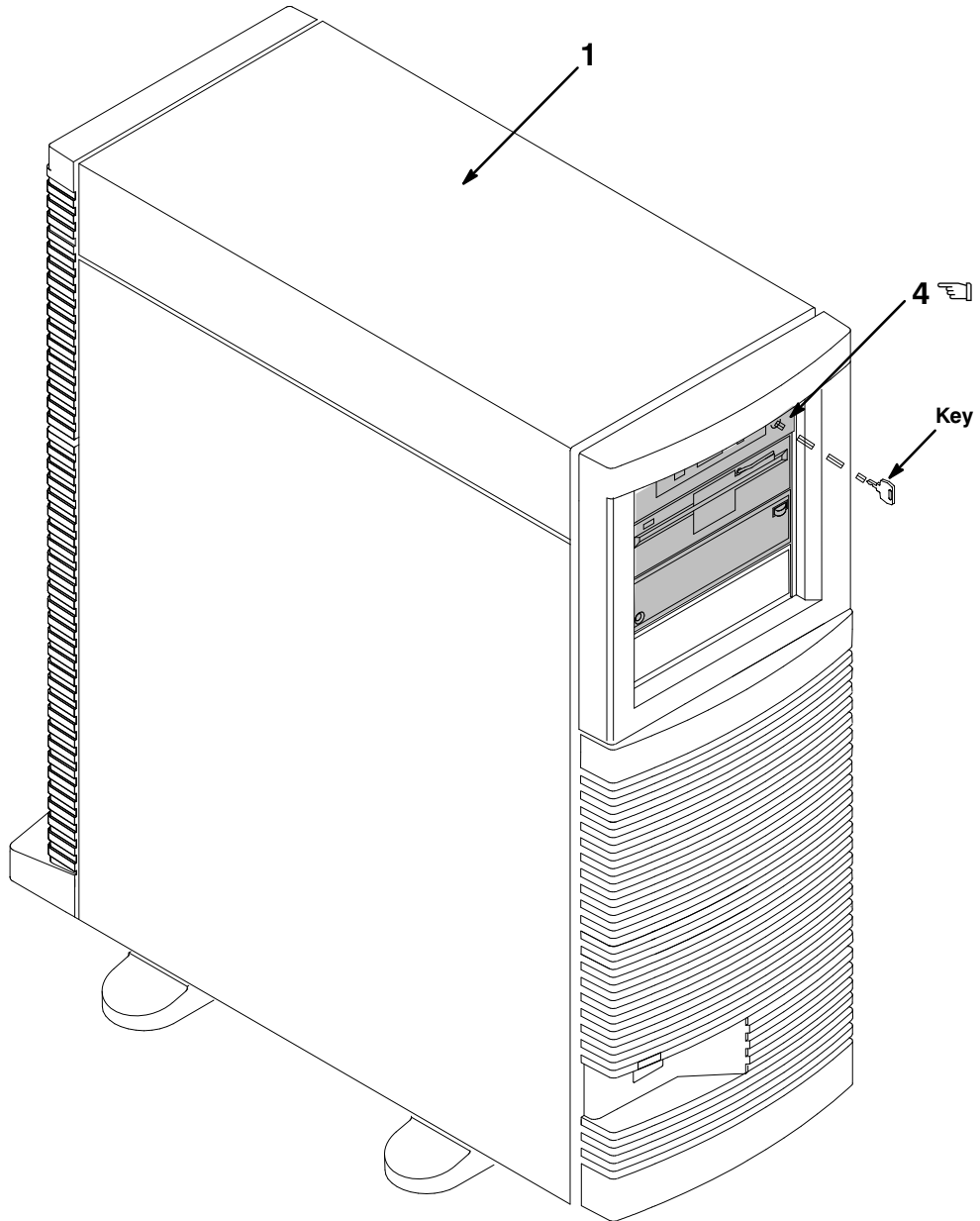

400XP-01-IL

Figure 1. applicationDEC 400xP System (Sheet 1 of 3)

INDICATES FRU LEVEL PARTS

INDICATES OPTIONAL PARTS

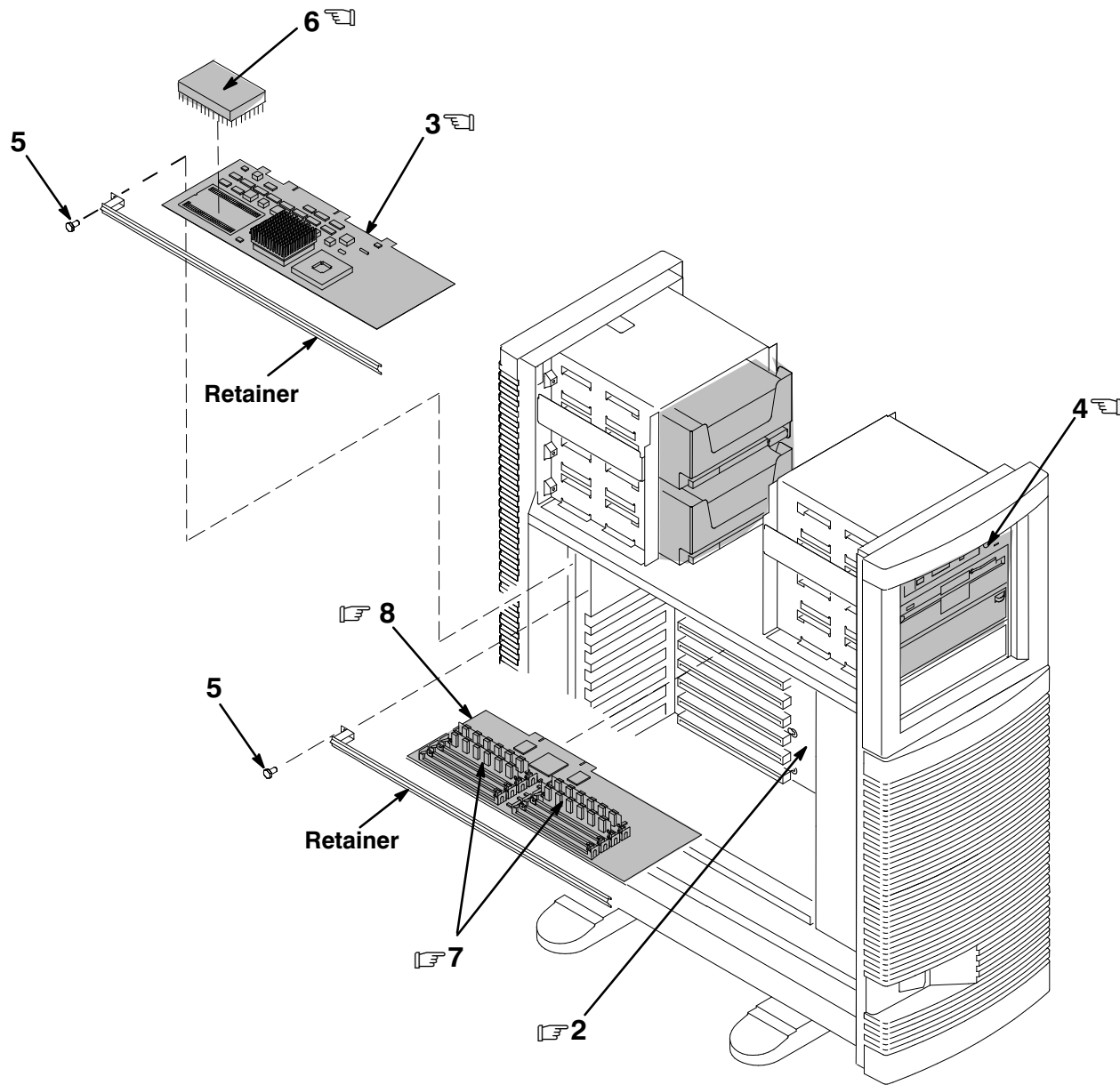

400XP-01A-IL

Figure 1. applicationDEC 400xP System (Sheet 2 of 3)

INDICATES FRU LEVEL PARTS

INDICATES OPTIONAL PARTS

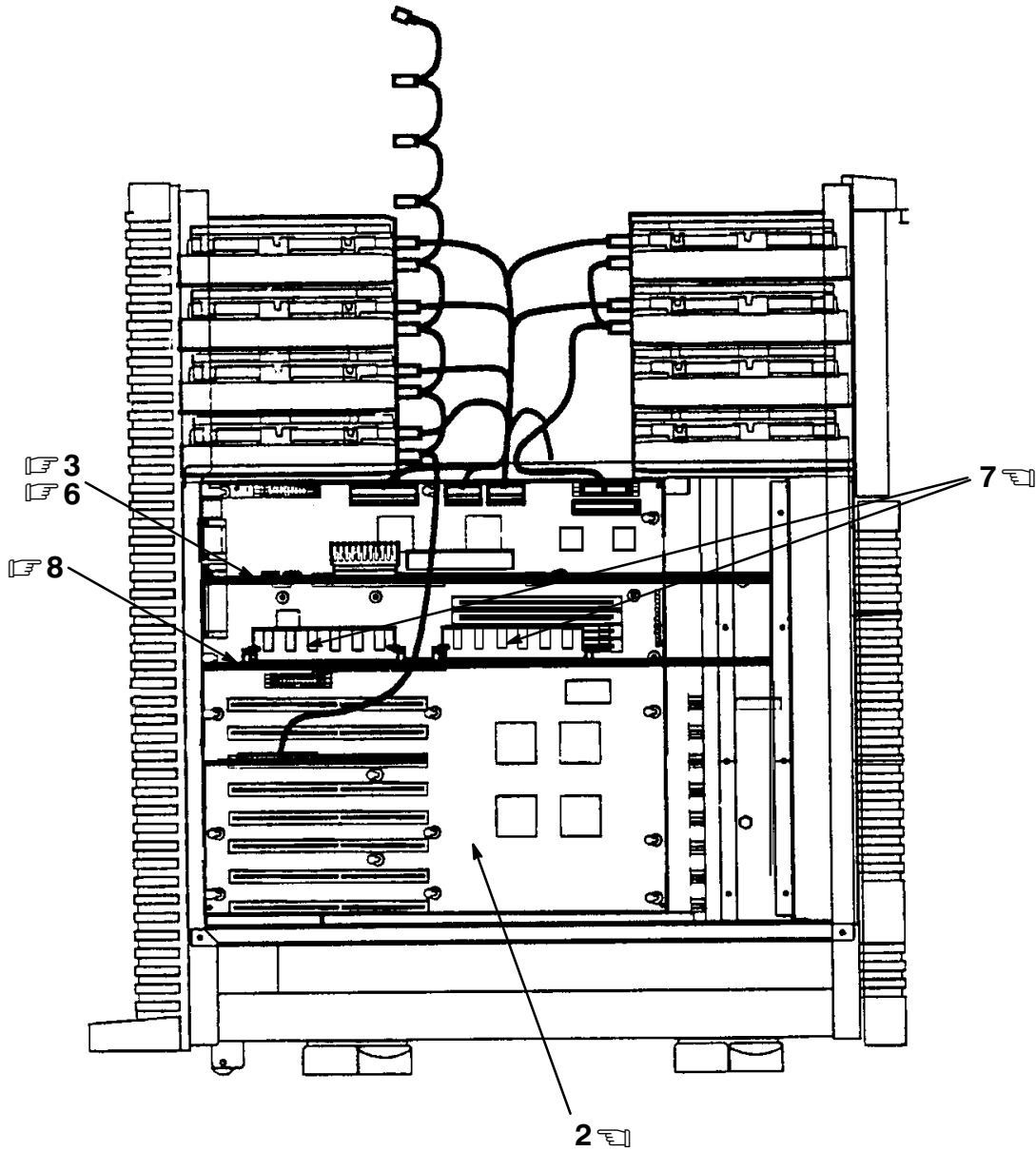

PARTS LIST



400XP-01A-SC

Figure 1. applicationDEC 400xP System (Sheet 3 of 3)

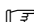
FIG. & ITEM NO.	DESCRIPTION	DEC PART NO. ^A	ECO CUT-IN	USED ON CODE	REF FIG NO.
1-	Code A – applicationDEC 400xP SYSTEM	PS200-A3		A	
	Code B – applicationDEC 400xP SYSTEM	PS200-AA		B	
	Code C – applicationDEC 400xP SYSTEM w/25 MHz CPU	PS201-A3		C	
	Code D – applicationDEC 400xP SYSTEM w/25 MHz CPU	PS201-AA		D	
	Code E – applicationDEC 400xP SYSTEM w/25 MHz CPU	PS201-BA		E	
	Code F – applicationDEC 400xP SYSTEM w/25 MHz CPU	PS201-B3		F	
	Code G – applicationDEC 400xP SYSTEM w/33 MHz CPU	PS202-AA		G	
	Code H – applicationDEC 400xP SYSTEM w/33 MHz CPU	PS202-A3		H	
	Code J – applicationDEC 400xP SYSTEM w/33 MHz CPU	PS202-BA		J	
	Code K – applicationDEC 400xP SYSTEM w/33 MHz CPU	PS202-B3		K	
	Code L – applicationDEC 400xP SYSTEM w/50 MHz CPU	PS203-AA		L	
	Code M – applicationDEC 400xP SYSTEM w/50 MHz CPU	PS203-A3		M	
	Code N – applicationDEC 400xP SYSTEM w/50 MHz CPU	PS203-BA		N	
	Code P – applicationDEC 400xP SYSTEM w/50 MHz CPU	PS203-B3		P	
1	*Kernel Assembly, PS20A	PS20A-A9			2
☞2	*Module, Main Logic (8 Slot EISA™)	30-37794-01			
☞3	*Module, CPU (25 MHz)	54-21819-01		CDEF	
☞	*Module, CPU (33 MHz)	54-21821-01		GHJK	
☞	*Module, CPU (50 MHz)	54-21823-01		LMNP	
☞4	*Drive, RX23 w/Grey Bezel	RX23-AA			
5	*Screw, Sems Phi Pan Hd No. 6-32 x 3/8	90-00049-24			
☞6	*Module, Cache Memory (64 KB)	19-32971-01			
☞	*Module, Cache Memory (128 KB)	19-32971-02			
☞7	*SIMM, (2 MB)	PS2XM-AA		AB	
☞	*SIMM, (4 MB)	PS2XM-BA		CDEF	
☞	*SIMM, (8 MB)	PS2XM-CA		GHJK	
☞	*SIMM, (16 MB)	PS2XM-DA		LMNP	
☞8	*Module, Memory Expansion	54-21817-01			

FIG. & ITEM NO.	DESCRIPTION	DEC PART NO.	ECO CUT-IN	USED ON CODE	REF FIG NO.
	<p style="text-align: center;">ITEMS (Not Shown)</p> <p> *Label, Regulatory</p> <p> *Cord, Power International</p> <p> *Cord, Power</p>	<p>36-38053-01</p> <p>70-28729-01</p> <p>17-00083-39</p>		<p>A,C,F,H, K,M,P B,D,E,G, J,L,N</p>	

 INDICATES FRU LEVEL PARTS

 INDICATES OPTIONAL PARTS

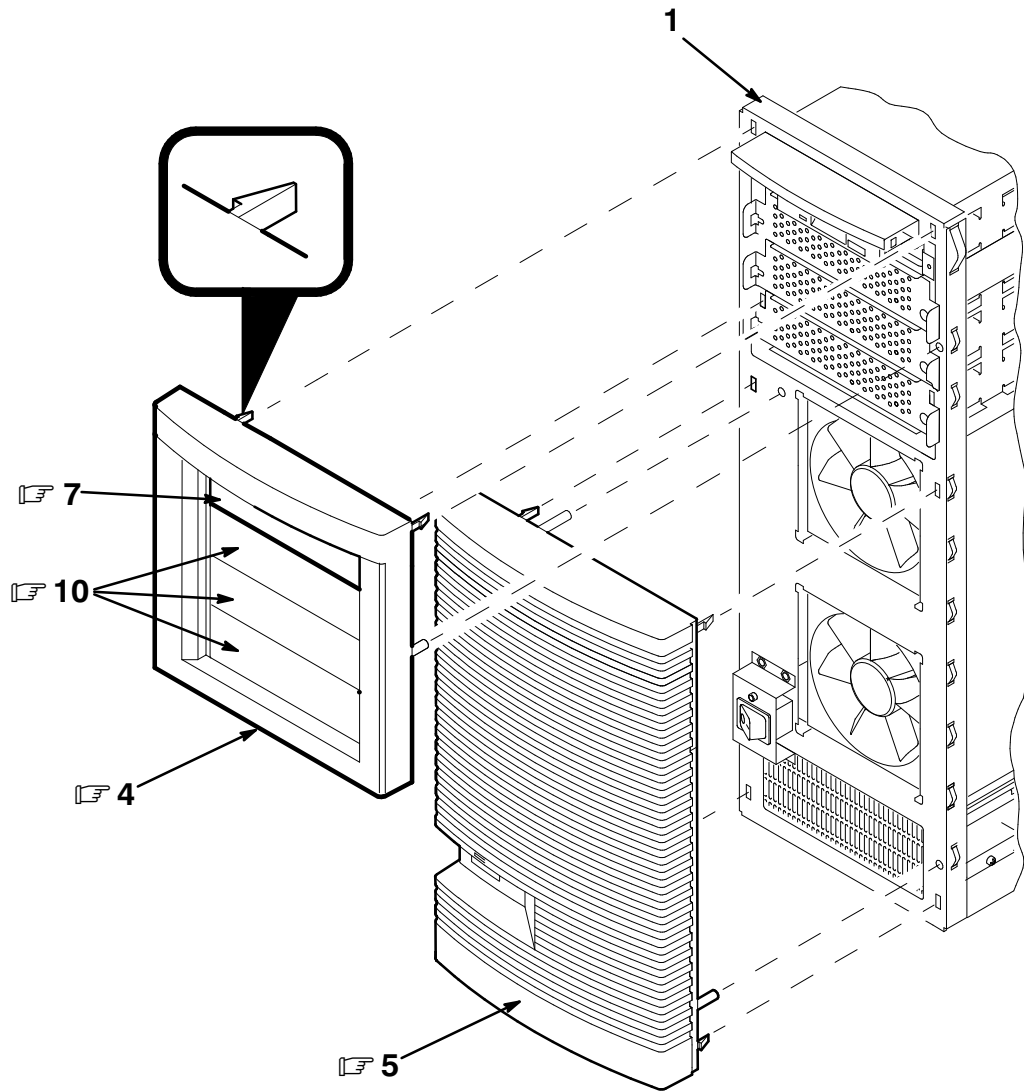

400XP-02-IL

Figure 2. Kernel Assembly, PS20A (Sheet 1 of 2)

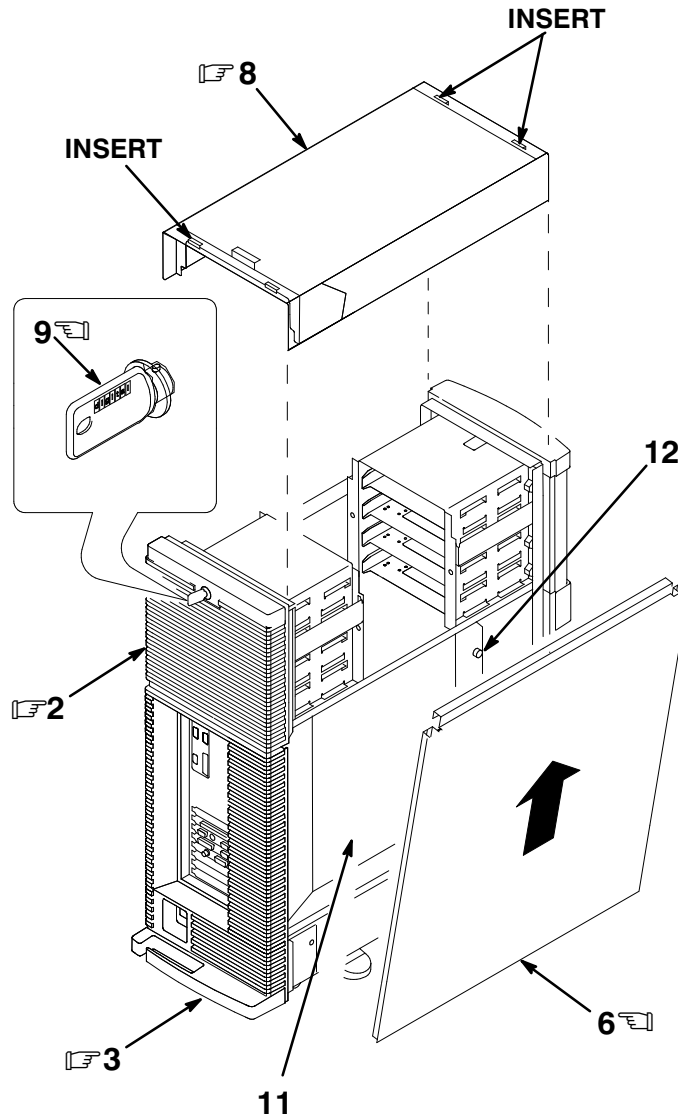

 INDICATES FRU LEVEL PARTS

 INDICATES OPTIONAL PARTS

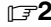
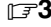
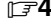
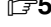
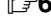
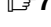
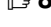
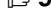

400XP-02A-IL

Figure 2. Kernel Assembly, PS20A (Sheet 2 of 2)

FIG. & ITEM NO.	DESCRIPTION	DEC PART NO. ^A	ECO CUT-IN PS20A 00000	USED ON CODE	REF FIG NO.
2-	KERNEL ASSEMBLY, PS20A	PS20A-A9			1
1	*UNIT ASSEMBLY	70-28257-01			3
 2	*Panel, Rear Upper	74-42776-01			
 3	*Panel, Rear Lower	74-43102-01			
 4	*Panel, Front Upper	74-42785-01			
 5	*Panel, Front Lower	70-28259-01			
 6	*Panel Assembly, Side	70-26616-01			
 7	*Insert, Opening (RX23)	74-43772-01			
 8	*Cover Assembly, Upper	70-28258-01			
 9	*Key, Plastic	12-17119-01			
 10	*Insert, Opening (General)	74-43772-01			
11	*Cover Assembly, Module	70-28272-01			
12	*Screw, Sems Phi Pan Hd No. 6-32 x 3/8	90-00049-24			
	ITEMS (Not Shown, Shipped Separately in Polybag.)				
	*Cable, Floppy (See Figure 3 Item 40.)	17-02985-02			
	*Screw, Mach. Flat Hd No. 6-32 x 1/4	90-11291-01			
	*Screw, Mach. Flat Hd M3 x 10 mm	90-40190-01			
	LABELS (Not Shown)				
	*Label, Direct Thermal	36-28231-08			
	*Label, Power Outlet	36-37659-01			
	*Label, Inner Slot Number	36-38046-01			
	*Label, Outer Slot Number	36-38046-02			
	*Label, SCSI Connection	36-38052-01			
	*Label, Regulatory	36-38053-01			

 INDICATES FRU LEVEL PARTS

 INDICATES OPTIONAL PARTS

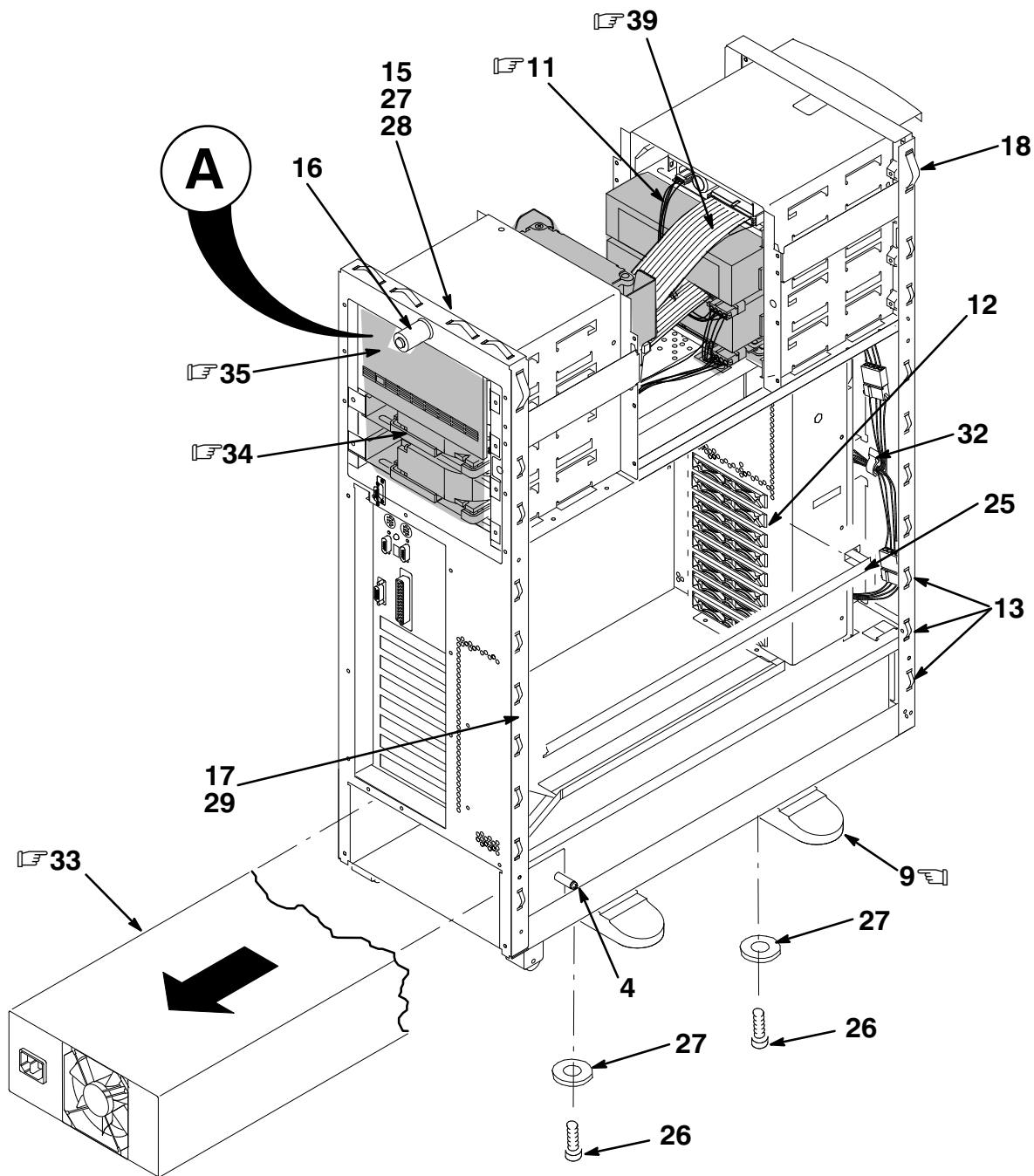

400XT-03-IL

Figure 3. Unit Assembly (Sheet 1 of 3)

INDICATES FRU LEVEL PARTS

PARTS LIST

INDICATES OPTIONAL PARTS

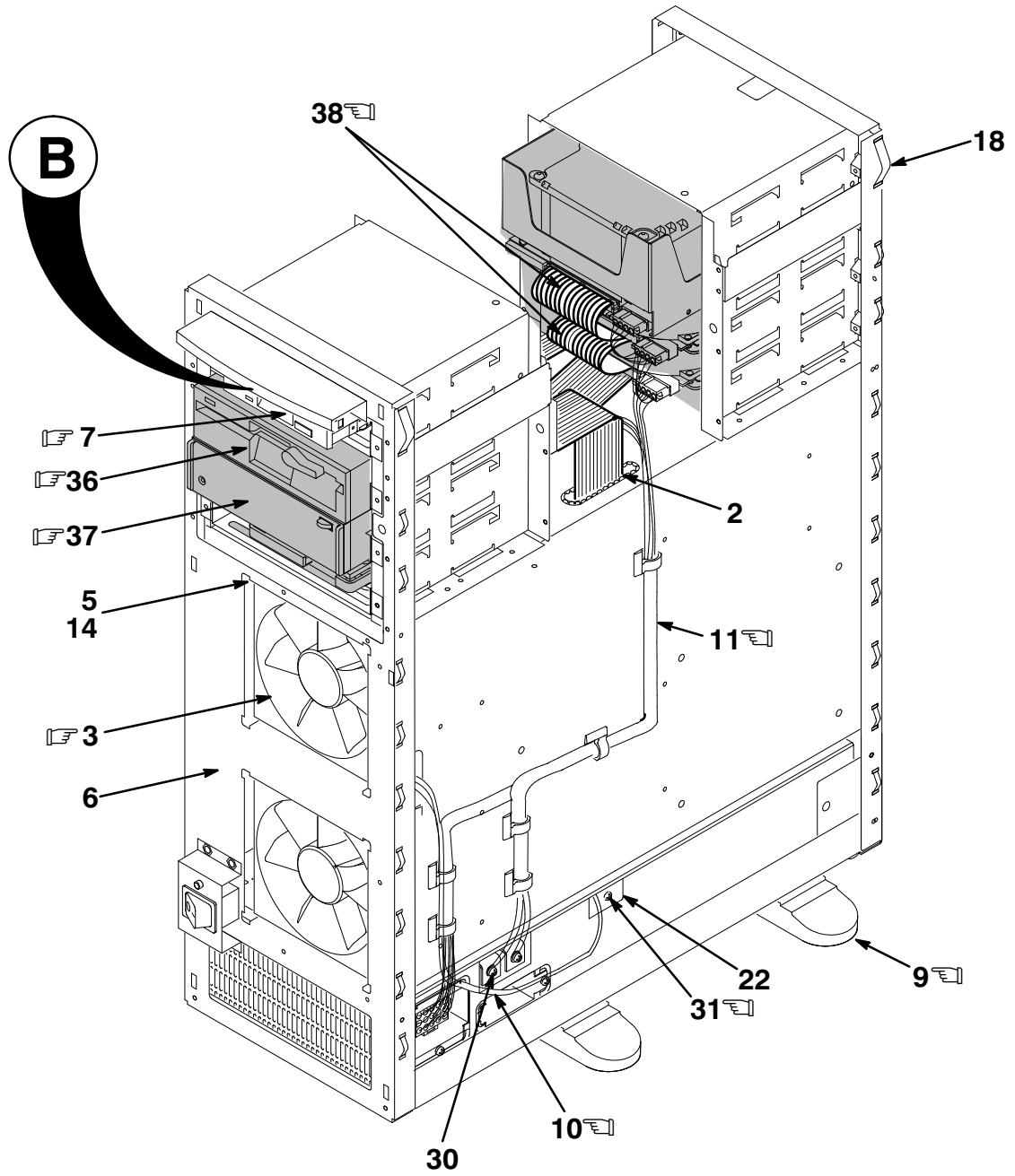

400XP-03A-IL

Figure 3. Unit Assembly (Sheet 2 of 3)

INDICATES FRU LEVEL PARTS

PARTS LIST

INDICATES OPTIONAL PARTS

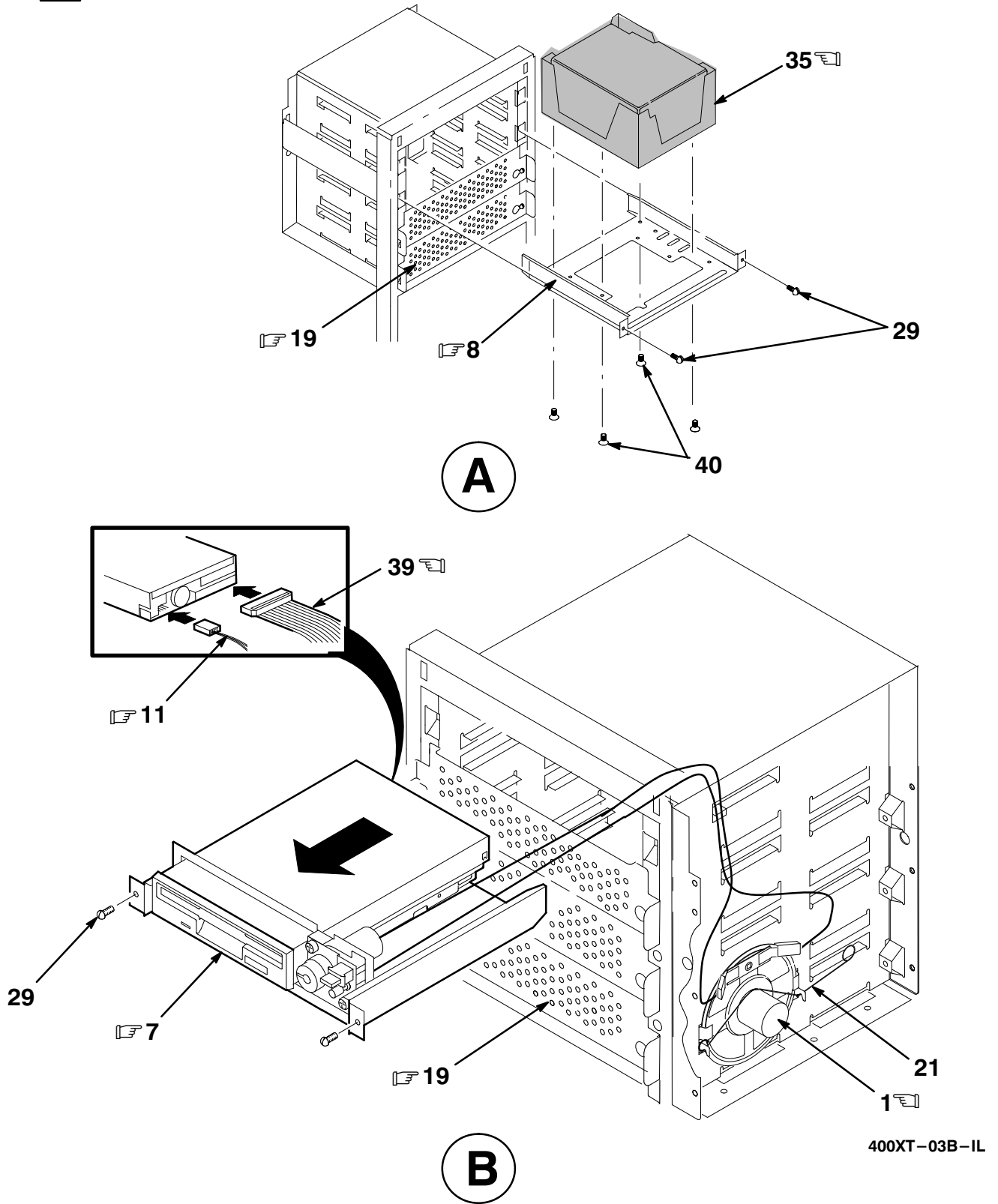

Figure 3. Unit Assembly (Sheet 3 of 3)

FIG. & ITEM NO.	DESCRIPTION	DEC PART NO. ^A	ECO CUT-IN 70-28257 00000	USED ON CODE	REF FIG NO.
3-	UNIT ASSEMBLY	70-28257-01			2
☞1	*Speaker	12-15050-00			
2	*Grommet, Length 8.46 inches	12-16903-01			
☞3	*Fan, Tube Axial (4.5 inch, Brushless, DC)	12-23609-11			
4	*Screw, Captive Phi Pan Hd No. 8-32 x 31/64	12-34832-01			
5	*Screw, Mach Truss Hd No. 6-32 x 1 27/32	12-35005-01			
6	*Chassis Assembly	70-28267-01			
☞7	*Drive Assembly, RX23	70-28281-01			
☞8	*Bracket Assembly, Drive	70-28285-01			
☞9	*Stand Assembly	70-28286-01			
☞10	*Cable Assembly, DC Switch	70-28294-01			
☞11	*Cable Assembly, Power System	70-28301-01			
12	*Guide, Card	74-41445-01			
13	*Plate, Ground	74-41454-01			
14	*Stopper, Fan Screw	74-41674-01			
15	*Wheel, Stroke	74-42135-01			
16	*Slider, Stroke	74-42137-01			
17	*Window, Cover/Chassis	74-42440-01			
18	*Ground Clip, Upper	74-42241-01			
☞19	*Shielding, Driver	74-43107-01			
20	*Clamp, Wire	74-43771-01			
21	*Spring, Speaker	74-43773-01			
22	*Cover, DC Switch	74-43989-01			
23	*Cap, Reset Switch	74-44155-01			
24	*Bumper, Fan	74-44157-01			
25	*Retainer	74-44336-01			
26	*Screw, Sems Phi Pan Hd No. 6-32 x 3/8	90-00049-24			
27	*Washer, Flat	90-06653-00			
28	*Nut, Kep No. 6-32	90-08185-00			
29	*Screw, Sems Phi Pan Hd No. 6-32 x 1/4	90-10174-00			
30	*Screw, Sems Phi Pan Hd No. 8-32 x 5/16	90-10174-01			
31	*Screw, Captive Phi Pan Hd No. 6-32 x 29/32	90-11204-01			
32	*Clip, Wire	90-40191-01			
☞33	*Power Supply (350 W)	H7882-AA			
☞34	*Drive Assembly, RZ2X	RZ2X-XX			
☞35	*Drive Assembly, RZ5X	RZ5X-XX			
☞36	*Drive, 5.25 inch Floppy	TLZ04-AA			
☞37	*Drive, Quick Tape	TZK10-AA			
☞38	*Cable Assembly, SCSI	17-03306-01			
☞39	Cable Assembly, Floppy (See Note)	17-02985-02			
40	Screw, Mach. Flat Hd No. 6-32 x 1/4 (See Note)	90-11291-01			
	NOTE: Part of Figure 2, Shown here for Clarity				
					Ω

PART NUMBER/DESCRIPTION INDEX 

INDEX BY DEC PART NUMBER
applicationDEC 400_xP SYSTEM

PART NO.	DESCRIPTION	FIG NO.	ITEM NO.
12-15050-00	Speaker	3	1
12-16903-01	Grommet, Length 8.46 inches	3	2
12-17119-01	Key, Plastic	2	9
12-23609-11	Fan, Tube Axial (4.5 inch, Brushless, DC)	3	3
12-34832-01	Screw, Captive Phi Pan Hd No. 8-32 x 31/64	3	4
12-35005-01	Screw, Mach Truss Hd No. 6-32 x 1 27/32	3	5
17-00083-39	Cord, Power (125V)	1	Not Shown
17-02985-02	Cable Assembly, Floppy	3	39
17-02985-02	Cable, Floppy (See Figure 3 Item 40.)	2	Not Shown
17-03306-01	Cable Assembly, SCSI	3	38
19-32971-01	Module, Cache Memory (64 KB)	1	6
19-32971-02	Module, Cache Memory (128 KB)	1	6
30-37794-01	Module, Main Logic (8 Slot EISA)	1	2
36-28231-08	Label, Direct Thermal	2	Not Shown
36-37659-01	Label, Power Outlet	2	Not Shown
36-38046-01	Label, Inner Slot Number	2	Not Shown
36-38046-02	Label, Outer Slot Number	2	Not Shown
36-38052-01	Label, SCSI Connection	2	Not Shown
36-38053-01	Label, Regulatory	1	Not Shown
36-38053-01	Label, Regulatory	2	Not Shown
54-21817-01	Module, Memory Expansion	1	8
54-21819-01	Module, CPU (25 MHz)	1	3
54-21821-01	Module, CPU (33 MHz)	1	3
54-21823-01	Module, CPU (50 MHz)	1	3
70-26616-01	Panel Assembly, Side	2	6
70-28257-01	UNIT ASSEMBLY	3	N/A
70-28257-01	UNIT ASSEMBLY	2	1
70-28258-01	Cover Assembly, Upper	2	8
70-28259-01	Panel, Front Lower	2	5
70-28267-01	Chassis Assembly	3	6
70-28272-01	Cover Assembly, Module	2	11
70-28281-01	Drive Assembly, RX23	3	7
70-28285-01	Bracket Assembly, Drive	3	8
70-28286-01	Stand Assembly	3	9
70-28294-01	Cable Assembly, DC Switch	3	10
70-28301-01	Cable Assembly, Power System	3	11
70-28729-01	Cord, Power International	1	Not Shown
74-41445-01	Guide, Card	3	12
74-41454-01	Plate, Ground	3	13
74-41674-01	Stopper, Fan Screw	3	14
74-42135-01	Wheel, Stroke	3	15
74-42137-01	Slider, Stroke	3	16
74-42241-01	Ground Cover, Upper	3	18
74-42440-01	Window, Cover/Chassis	3	17
74-42776-01	Panel, Rear Upper	2	2
74-42785-01	Panel, Front Upper	2	4
74-43102-01	Panel, Rear Lower	2	3
74-43107-01	Shielding, Driver	3	19
74-43771-01	Clamp, Wire	3	20

INDEX BY DEC PART NUMBER
applicationDEC 400_xP SYSTEM

PART NO.	DESCRIPTION	FIG NO.	ITEM NO.
74-43772-01	Insert, Opening (General)	2	10
74-43772-01	Insert, Opening (RX23)	2	7
74-43773-01	Spring, Speaker	3	21
74-43989-01	Cover, DC Switch	3	22
74-44155-01	Cap, Reset Switch	3	23
74-44157-01	Bumper, Fan	3	24
74-44336-01	Retainer	3	25
90-00049-24	Screw, Sems Phi Pan Hd No. 6-32 x 3/8	1	5
90-00049-24	Screw, Sems Phi Pan Hd No. 6-32 x 3/8	2	12
90-00049-24	Screw, Sems Phi Pan Hd No. 6-32 x 3/8	3	26
90-06653-00	Washer, Flat	3	27
90-08185-00	Nut, Kep No. 6-32	3	28
90-10174-00	Screw, Sems Phi Pan Hd No. 6-32 x 1/4	3	29
90-10174-01	Screw, Sems Phi Pan Hd No. 8-32 x 5/16	3	30
90-11204-01	Screw, Captive Phi Pan Hd No. 6-32 x 29/32	3	31
90-11291-01	Screw, Mach. Flat Hd No. 6-32 x 1/4	2	Not Shown
90-11291-01	Screw, Mach. Flat Hd No. 6-32 x 1/4	3	40
90-40190-01	Screw, Mach. Flat Hd M3 x 10 mm	2	Not Shown
90-40191-01	Clip, Wire	3	32
H7882-AA	Power Supply (350W)	3	33
PS200-A3	applicationDEC 400xP SYSTEM w/International Pwr Cord	1	N/A
PS200-AA	applicationDEC 400xP SYSTEM w/Pwr Cord (125V)	1	N/A
PS201-A3	applicationDEC 400xP SYSTEM w/25 MHz CPU w/International Pwr Cord	1	N/A
PS201-AA	applicationDEC 400xP SYSTEM w/25 MHz CPU w/Pwr Cord (125V)	1	N/A
PS201-B3	applicationDEC 400xP SYSTEM w/25 MHz CPU w/International Pwr Cord	1	N/A
PS201-BA	applicationDEC 400xP SYSTEM w/25 MHz CPU w/Pwr Cord (125V)	1	N/A
PS202-A3	applicationDEC 400xP SYSTEM w/33 MHz CPU w/International Pwr Cord	1	N/A
PS202-AA	applicationDEC 400xP SYSTEM w/33 MHz CPU w/Pwr Cord (125V)	1	N/A
PS202-B3	applicationDEC 400xP SYSTEM w/33 MHz CPU w/International Pwr Cord	1	N/A
PS202-BA	applicationDEC 400xP SYSTEM w/33 MHz CPU w/Pwr Cord (125V)	1	N/A
PS203-A3	applicationDEC 400xP SYSTEM w/50 MHz CPU w/International Pwr	1	N/A
PS203-AA	applicationDEC 400xP SYSTEM w/50 MHz CPU w/Pwr Cord (125V)	1	N/A
PS203-B3	applicationDEC 400xP SYSTEM w/50 MHz CPU w/International Pwr Cord	1	N/A
PS203-BA	applicationDEC 400xP SYSTEM w/50 MHz CPU w/Pwr Cord (125V)	1	N/A
PS20A-A9	KERNEL ASSEMBLY, PS20A	2	N/A
PS20A-A9	Kernel Assembly, PS20A	1	1
PS2XM-AA	Module, SIMM (2 MB)	1	7
PS2XM-BA	Module, SIMM (4 MB)	1	7
PS2XM-CA	Module, SIMM (8 MB)	1	7
PS2XM-DA	Module, SIMM (16 MB)	1	7

INDEX BY DEC PART NUMBER
applicationDEC 400_xP SYSTEM

PART NO.	DESCRIPTION	FIG NO.	ITEM NO.
RX23-AA	Drive, RX23 w/Grey Bezel	1	4
RZ2X-XX	Drive Assembly, RZ2X	3	34
RZ5X-XX	Drive Assembly, RZ5X	3	35
TLZ04-AA	Drive, 5.25 inch Floppy	3	36
TZK10-AA	Drive, Quick Tape	3	37

INDEX BY DEC PART DESCRIPTION

applicationDEC 400_xP SYSTEM

DESCRIPTION	DEC PART NO.	FIG. NO.	ITEM NO.
applicationDEC 400xP SYSTEM w/25 MHZ CPU w/Pwr Cord (125V)	PS201-AA	1	N/A
applicationDEC 400xP SYSTEM w/25 MHZ CPU w/Pwr Cord (125V)	PS201-BA	1	N/A
applicationDEC 400xP SYSTEM w/25 MHz CPU w/International Pwr Cord	PS201-A3	1	N/A
applicationDEC 400xP SYSTEM w/25 MHz CPU w/International Pwr Cord	PS201-B3	1	N/A
applicationDEC 400xP SYSTEM w/33 MHz CPU w/International Pwr Cord	PS202-A3	1	N/A
applicationDEC 400xP SYSTEM w/33 MHz CPU w/International Pwr Cord	PS202-B3	1	N/A
applicationDEC 400xP SYSTEM w/33 MHz CPU w/Pwr Cord (125V)	PS202-AA	1	N/A
applicationDEC 400xP SYSTEM w/33 MHz CPU w/Pwr Cord (125V)	PS202-BA	1	N/A
applicationDEC 400xP SYSTEM w/50 MHz CPU w/International Pwr Cord	PS203-A3	1	N/A
applicationDEC 400xP SYSTEM w/50 MHz CPU w/International Pwr Cord	PS203-B3	1	N/A
applicationDEC 400xP SYSTEM w/50 MHz CPU w/Pwr Cord (125V)	PS203-AA	1	N/A
applicationDEC 400xP SYSTEM w/50 MHz CPU w/Pwr Cord (125V)	PS203-BA	1	N/A
applicationDEC 400xP SYSTEM w/International Pwr Cord	PS200-A3	1	N/A
applicationDEC 400xP SYSTEM w/Pwr Cord (125V)	PS200-AA	1	N/A
Bracket Assembly, Drive	70-28285-01	3	8
Bumper, Fan	74-44157-01	3	24
Cable Assembly, DC Switch	70-28294-01	3	10
Cable Assembly, Floppy	17-02985-02	3	39
Cable Assembly, Power System	70-28301-01	3	11
Cable Assembly, SCSI	17-03306-01	3	38
Cable, Floppy (See Figure 3 Item 40.)	17-02985-02	2	Not Shown
Cap, Reset Switch	74-44155-01	3	23
Chassis Assembly	70-28267-01	3	6
Clamp, Wire	74-43771-01	3	20
Clip, Wire	90-40191-01	3	32
Cord, Power (125V)	17-00083-39	1	Not Shown
Cord, Power International	70-28729-01	1	Not Shown
Cover Assembly, Module	70-28272-01	2	11
Cover Assembly, Upper	70-28258-01	2	8
Cover, DC Switch	74-43989-01	3	22
Drive Assembly, RX23	70-28281-01	3	7
Drive Assembly, RZ2X	RZ2X-XX	3	34
Drive Assembly, RZ5X	RZ5X-XX	3	35
Drive, 5.25 inch Floppy	TLZ04-AA	3	36
Drive, Quick Tape	TZK10-AA	3	37
Drive, RX23 w/Grey Bezel	RX23-AA	1	4
Fan, Tube Axial (4.5 inch, Brushless, DC)	12-23609-11	3	3
Grommet, Length 8.46 inches	12-16903-01	3	2
Ground Cover, Upper	74-42241-01	3	18
Guide, Card	74-41445-01	3	12

INDEX BY DEC PART DESCRIPTION

application DEC 400_xP SYSTEM

DESCRIPTION	DEC PART NO.	FIG. NO.	ITEM NO.
Insert, Opening (General)	74-43772-01	2	10
Insert, Opening (RX23)	74-43772-01	2	7
KERNEL ASSEMBLY, PS20A	PS20A-A9	2	N/A
Kernel Assembly, PS20A	PS20A-A9	1	1
Key, Plastic	12-17119-01	2	9
Label, Direct Thermal	36-28231-08	2	Not Shown
Label, Inner Slot Number	36-38046-01	2	Not Shown
Label, Outer Slot Number	36-38046-02	2	Not Shown
Label, Power Outlet	36-37659-01	2	Not Shown
Label, Regulatory	36-38053-01	1	Not Shown
Label, Regulatory	36-38053-01	2	Not Shown
Label, SCSI Connection	36-38052-01	2	Not Shown
Module, CPU (25 MHz)	54-21819-01	1	3
Module, CPU (33 MHz)	54-21821-01	1	3
Module, CPU (50 MHz)	54-21823-01	1	3
Module, Cache Memory (128 KB)	19-32971-02	1	6
Module, Cache Memory (64 KB)	19-32971-01	1	6
Module, Main Logic (8 Slot EISA)	30-37794-01	1	2
Module, Memory Expansion	54-21817-01	1	8
Module, SIMM (16 MB)	PS2XM-DA	1	7
Module, SIMM (2 MB)	PS2XM-AA	1	7
Module, SIMM (4 MB)	PS2XM-BA	1	7
Module, SIMM (8 MB)	PS2XM-CA	1	7
Nut, Kep No. 6-32	90-08185-00	3	28
Panel Assembly, Side	70-26616-01	2	6
Panel, Front Lower	70-28259-01	2	5
Panel, Front Upper	74-42785-01	2	4
Panel, Rear Lower	74-43102-01	2	3
Panel, Rear Upper	74-42776-01	2	2
Plate, Ground	74-41454-01	3	13
Power Supply (350W)	H7882-AA	3	33
Retainer	74-44336-01	3	25
Screw, Captive Phl Pan Hd No. 6-32 x 29/32	90-11204-01	3	31
Screw, Captive Phl Pan Hd No. 8-32 x 31/64	12-34832-01	3	4
Screw, Mach Truss Hd No. 6-32 x 1 27/32	12-35005-01	3	5
Screw, Mach. Flat Hd M3 x 10 mm	90-40190-01	2	Not Shown
Screw, Mach. Flat Hd No. 6-32 x 1/4	90-11291-01	2	Not Shown
Screw, Mach. Flat Hd No. 6-32 x 1/4	90-11291-01	3	40
Screw, Sems Phl Pan Hd No. 6-32 x 1/4	90-10174-00	3	29
Screw, Sems Phl Pan Hd No. 6-32 x 3/8	90-00049-24	1	5
Screw, Sems Phl Pan Hd No. 6-32 x 3/8	90-00049-24	2	12
Screw, Sems Phl Pan Hd No. 6-32 x 3/8	90-00049-24	3	26
Screw, Sems Phl Pan Hd No. 8-32 x 5/16	90-10174-01	3	30
Shielding, Driver	74-43107-01	3	19
Slider, Stroke	74-42137-01	3	16
Speaker	12-15050-00	3	1
Spring, Speaker	74-43773-01	3	21
Stand Assembly	70-28286-01	3	9
Stopper, Fan Screw	74-41674-01	3	14

INDEX BY DEC PART DESCRIPTION
applicationDEC 400_xP SYSTEM

DESCRIPTION	DEC PART NO.	FIG. NO.	ITEM NO.
UNIT ASSEMBLY	70-28257-01	2	1
UNIT ASSEMBLY	70-28257-01	3	N/A
Washer, Flat	90-06653-00	3	27
Wheel, Stroke	74-42135-01	3	15
Window, Cover/Chassis	74-42440-01	3	17